

INSTALL INSTRUCTIONS

Indoor MGDS2 for Axis Cameras



APPLICABLE MODELS

- MGDS2-BGAXFXID (smoked dome)
- MGDS2-CGAXFXID (clear dome)

DESCRIPTION

The surface detention grade MiniGlobe (MGDS2) provides an extremely durable, integrated solution for indoor and outdoor security applications. Use the MGDS2 in critical public locations, mounted anywhere on a wall or ceiling less than 10 feet from the ground.

Note: This housing is designed to be used with the following Axis camera model numbers: P3301, P3304, P3343, P3344, M3203, M3204

SUGGESTED INSTALLATION EQUIPMENT

- Power Drill
- Small Flat Head Screwdriver
- 3/16" Concrete Drill Bit
- #8 Toggle Bolts
- 1/4" Concrete Anchors, 2
- 1/4" Sealing Washers, neoprene, 2
- 1/2" Conduit Connector
- Teflon tape or thread sealer

COMPONENT LIST (See Figure 1)

- A. Housing Base
- B. Axis Camera Bracket
- C. Axis Camera (packaged separately)
- D. Screw, Pan Hd. Phil #8-32 x 1/2" (2)
- E. Dome and Trim Ring Assembly
- F. Tamper-Resistant Screws (4)
- G. Hex Wrench (1) (not shown)

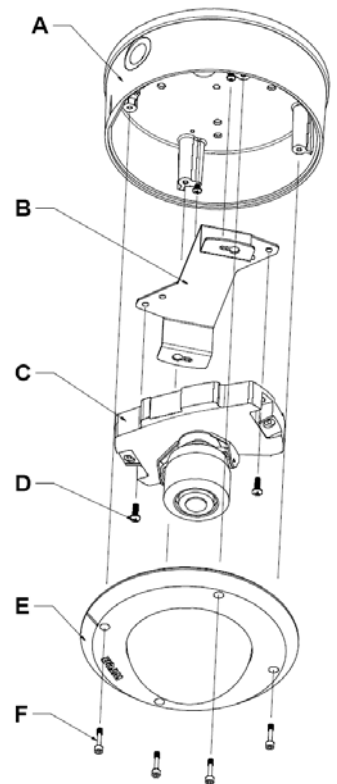

Figure 1

WARNINGS AND SAFEGUARDS

Prior to installation and use of this product, please observe the following warnings:

1. Installation and servicing should be done by qualified personnel, and all work done should conform to local codes.
2. Using replacement parts or accessories other than Wren may invalidate the warranty.
3. Make sure that the installation method is capable of supporting three (3) times the weight of the MGDS housing and enclosed contents.
4. For outdoor installations, especially those on rough vertical surfaces, additional sealing methods may be required to prevent moisture from entering the housing.

PREPARATION

1. Carefully unpack box and verify that all components listed in the component list are included.
2. Establish desired location for unit.
3. Remove dome assembly and set aside carefully to ensure it does not become scratched.
4. Run appropriate wiring:
 - Ethernet (CAT5, to camera)
 - 18-2 cable (Used with heater/blower-equipped units only, Power supply used should be capable of supplying 24VAC, 1.5 amps)

INSTALLATION (Housing)

A. Concrete

WARNING

The following instructions assume installation on vertical concrete wall using Tapcon ¼" x 1.75" concrete anchors or equivalent. The installer must ensure that the fasteners being used are appropriate for the intended application.

1. Drill out two or more of the recessed holes in the base housing. See Figure 2 for recessed hole to junction box relation if junction box is used.
2. Use holes in the back of the base housing as a template to mark hole positions for the fasteners in the desired location.
3. Drill two 3/16" holes in the marked locations.
4. Drill a clearance hole large enough for the conduit fittings into the wall.
5. Attach the conduit connector to the housing and run cabling into the housing.
6. Install ½" enclosure plug in unused cable opening (side or back). Seal threads with Teflon tape or thread sealant.
7. Attach housing to the wall using concrete anchors*, putting the sealing washers between the head of the anchor and the housing body, with the rubber side against the housing. (Figure 3)

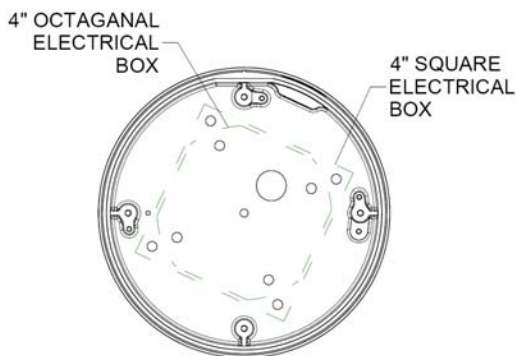

Figure 2

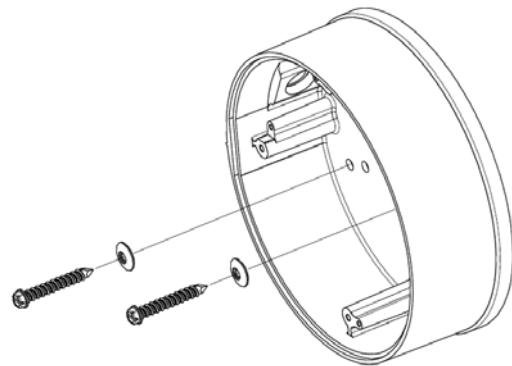

Figure 3

NOTE

Liquid sealant should be used around the conduit to prevent leaking into the building.

B. Sheetrock/Drywall

1. Drill out two or more of the recessed holes in the base housing. See Figure 2 for recessed hole to junction box relation if junction box is used.
2. Use the drilled out holes as a template to mark drill locations on the surface.
3. Drill appropriately sized holes for #8 toggle bolts into the surface.
4. Drill appropriately sized hole for cable access.

5. Pull the cable through the hole and into the housing.
6. Install ½" enclosure plug in unused cable opening (side or back). Seal threads with Teflon tape or thread sealant.
7. Use #8 toggle bolts to secure the housing to the surface.

C. Electrical Junction Box

1. Drill out two or more of the recessed holes in the base housing. See Figure 2 for recessed hole to junction box relation if junction box is used.
2. Pull cable from the junction box through the cable access hole on the housing.
3. Install ½" enclosure plug in unused cable opening (side or back). Seal threads with Teflon tape or thread sealant.
4. Mount the housing to the junction box using appropriate hardware (not included).

INSTALLATION (Camera)

1. Attach Ethernet RJ45 cable to the camera.
2. Mount the camera into the housing (see Figure 1), positioning the camera such that RJ45 connection is near to the cable access hole. Use the included #10 screws to secure the camera to the housing.
3. Make necessary adjustments to the lens (see camera instructions for details).
4. Position liner so that the opening is lined up with the camera view.
5. Attach the dome assembly to the base housing by tightening the four (4) hex screws using the included hex wrench.

TROUBLESHOOTING

1. If there is no video signal refer to the Axis camera instruction sheet for trouble shooting information.

MECHANICAL PROPERTIES

- Upper unit: Cast Aluminum
- Lower unit: Polycarbonate in Cast Aluminum trim ring
- Unit weight: 3.0 lbs without camera
- Shipping weight: 3.7 lbs without camera

ELECTRICAL PROPERTIES

- Power Supply, Camera: 5V DC, or POE

ENVIRONMENT

- Indoor or Outdoor

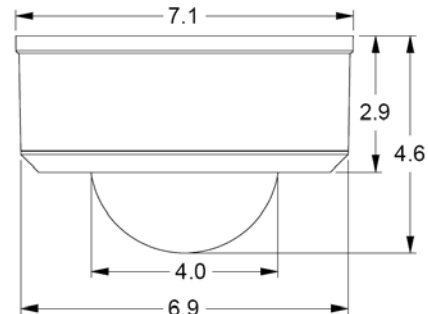

All products are subject to the current version of Wren Terms and Conditions

WREN LIMITED MANUFACTURER'S WARRANTY

Unless otherwise noted, all products are covered by Wren's Standard Limited Manufacturer's Warranty as set forth in the current version of Wren's Terms and Conditions. For a copy of the Terms and Conditions please use the contact information below.

RETURNS

In order to return parts to the factory for repair or credit, please call the factory at (800) 881-2249 or (573) 893-2249 to obtain a Return Authorization (RA) number. All returns are subject to Wren's RA Policy. Goods returned for credit should be in their original condition—new and unused. Merchandise may be returned by the Customer for credit within 30 calendar days from the invoice date. Products may not be returned more than 31 calendar days from the invoice date. Custom, special order and OEM products may not be returned.

Wren®, the Wren logo, The Power to See Your Business, Wren IP Solutions, No Tools Required and Solution Set Series are trademarks of Wren. The trademarks that are followed by ® are registered trademarks in the U.S. All other trademarks and/or registered trademarks mentioned herein are properties of their respective owners and are used for reference purposes only. The use of these trademarks does not indicate any affiliation with or sponsorship of or by Wren. ©2006 Wren. All rights reserved.